

The Park

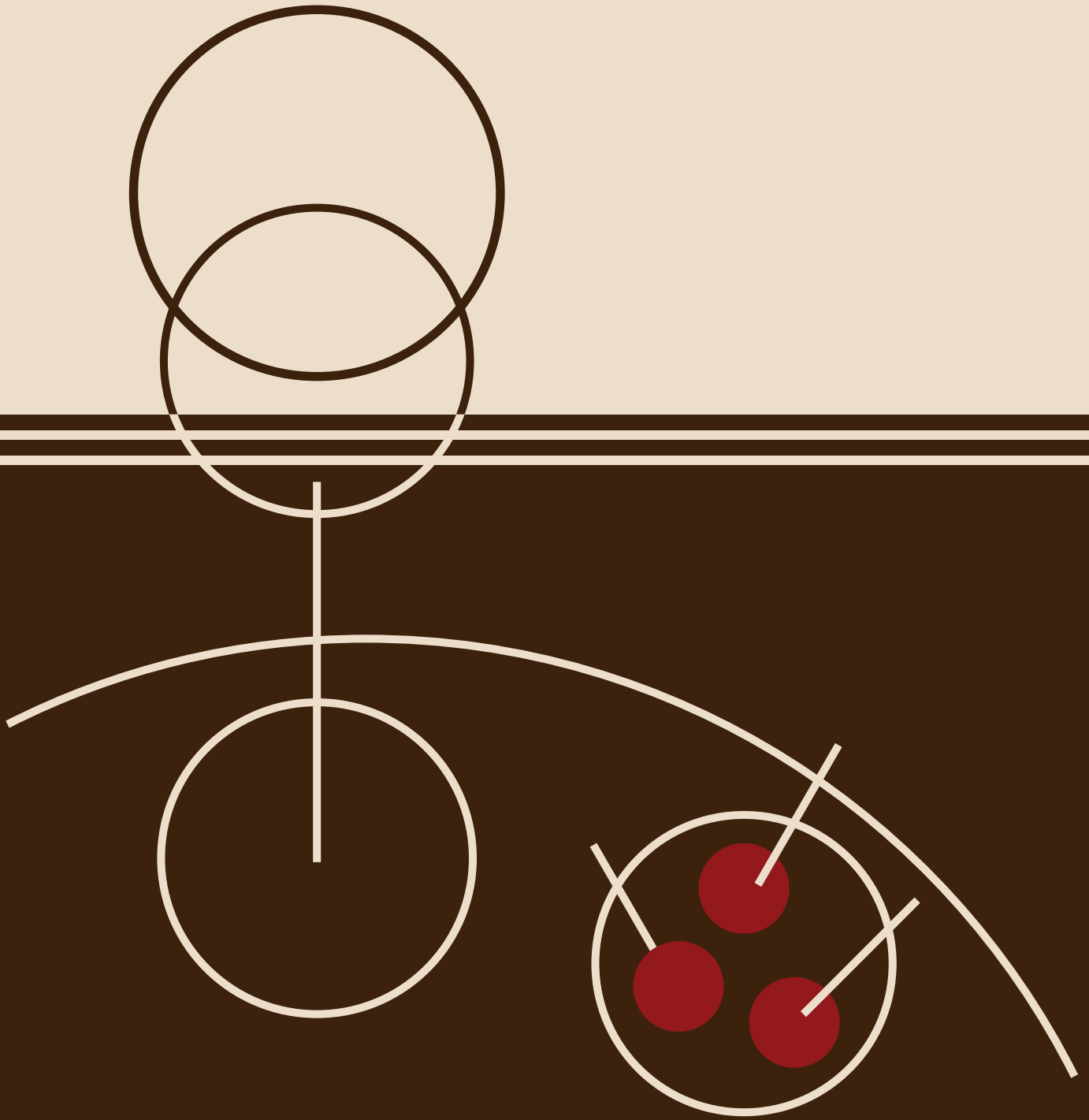

PRIVATE DINING



THE PARK

The Park is the latest restaurant from Jeremy King Restaurants.

With its corner position in the prestigious Park Modern building, The Park is a grand café for the 21st century, combining sophisticated contemporary design with a strong modernist Manhattan touch. Open seven days a week from early until late into the evening, The Park is magnificently located directly opposite Kensington Gardens, where Bayswater Road meets Queensway.



THE MANHATTAN ROOM

Seating 12 guests, the private dining room is located in utter privacy on the lower ground floor and is available to book seven days a week, for breakfast, lunch or dinner, with set menus available for each sitting.

The room is equally suited to small meetings, with extensive AV facilities discreetly hidden.

It features African Limba wood panelling, a large marquetry table, chairs upholstered in sunset orange leather and velvet-covered banquettes. The coffered ceiling features a hand-painted mural depicting a bird's eye view of Manhattan's Central Park by the British scenic artist Michael May.

Lighting blends Art Deco and contemporary elements, and the room is hung with a collection of iconic, full technicolour photographs by the renowned photographer Horst P. Horst.



FOOD & DRINK

The Park serves contemporary American food with its strong Italian influences, favouring simple presentation and excellent ingredients. Desserts are all-American.

The wine list is primarily Italian or North American, with a focus on Californian wines.

Our cocktails have a classic DNA, including old school classics that stay true to the original recipes, contemporary variations on classics or contemporary classics.

There is also a sophisticated choice of alcohol-free cocktails.

MENUS

Please select one menu for your party.

Dietary requirements can be catered for.

All dishes are subject to seasonal changes.

We can provide celebration cakes.

If you wish to provide your own cake, a fee of £5.00 per guest will be charged.





AT A GLANCE

Capacity – up to 12 people, seated at one table.

Menus and place cards are complimentary and designed to your requirements.

Candles will be provided.

Flowers – please ask us for local florist recommendations.

Background music – please ask us if you have a particular music selection you wish to play.

AV equipment includes large television screen and connecting aux cables.

Complimentary Wi-Fi.

~

Disabled access and lift.

PRICING

We do not charge room hire, but a minimum spend applies, as outlined in our Terms and Conditions.

Corkage charge is £40 per bottle of wine and £50 per bottle of Champagne.

A discretionary 15% service charge will be added to your bill.

All prices include VAT at the current rate.

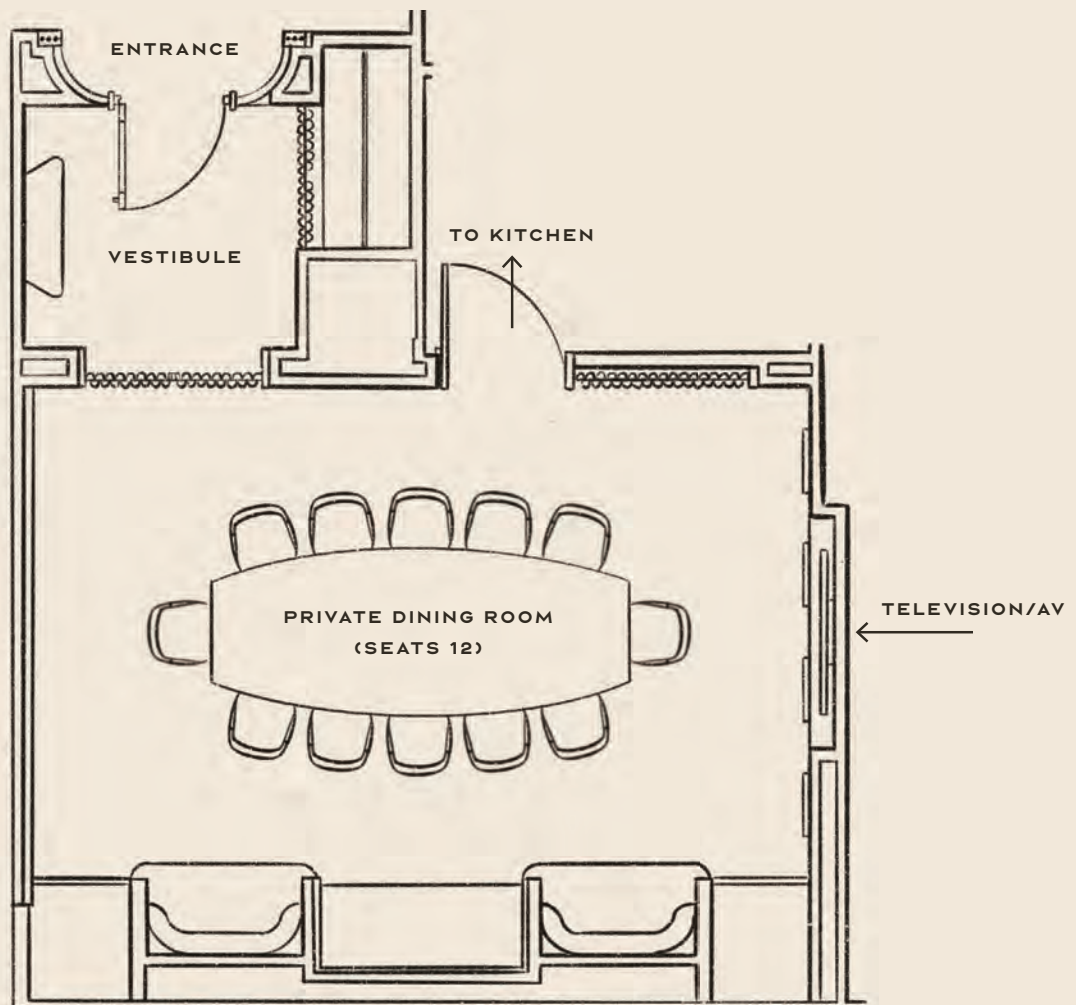

TO BOOK

CALL: 020 3959 9000

EMAIL: PRIVATEDINING@THEPARKRESTAURANT.COM

CHECK LIVE AVAILABILITY ONLINE:

WWW.THEPARKRESTAURANT.COM/PRIVATE-DINING



LOCATION

Situated halfway between Marble Arch and Notting Hill Gate, and just a few steps from Kensington Gardens, with Queensway Underground Station directly opposite, The Park's private dining room is easy to reach.

THE PARK OPENING HOURS

Monday – Friday, 07:00 - 23:00

Saturday - 08:00 - 23:00

Sunday - 08:00 - 22:00

MANHATTAN ROOM ACCESS AND SERVICE TIMES

Breakfast (access) 7am | (service) 7.30am – 10.30am

Lunch (access) 11.30pm | (service) 12pm - 4.00pm

Dinner (access) Monday – Sunday 6pm

Dinner (service) Monday – Saturday 6.30pm - 12.00am, Sunday 6.30pm - 11.30pm

The Park

T: 020 3959 9000

2 QUEENSWAY, LONDON W2 3RX

WWW.THEPARKRESTAURANT.COM/PRIVATE-DINING

PRIVATEDINING@THEPARKRESTAURANT.COM